

## AMERICAN FLANGES

**18A**  
CHOKE + SEALING GROOVE

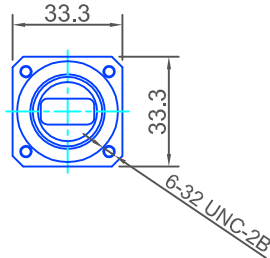

UG-541A/U  
(MIL-F-3922/59-001)

**18B**  
COVER / PLAIN

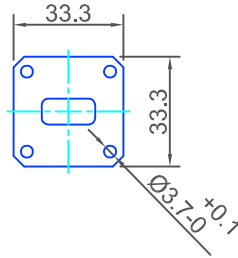

UG-419/U  
(MIL-F-3922/53-005)

**18Y**  
SEALING GROOVE

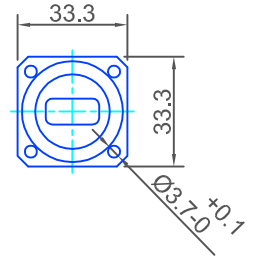

UG-419/U *Modified*  
MIL-F-3922/53-005 *Modified*

## EUROPEAN FLANGES

**18G**  
CHOKE + SEALING GROOVE

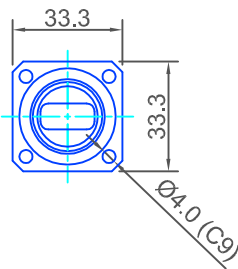

154 IEC-CBR 140

**18K**  
SEALING GROOVE

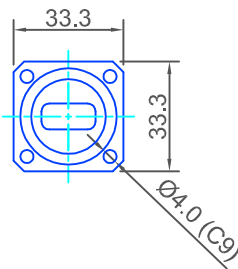

154 IEC-PBR 140

**18M**  
COVER / PLAIN

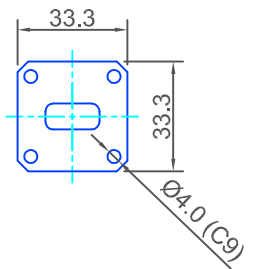

154 IEC-UBR 140

**18H**  
SEALING GROOVE

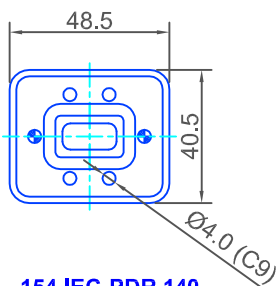

154 IEC-PDR 140

**18L**  
COVER / PLAIN

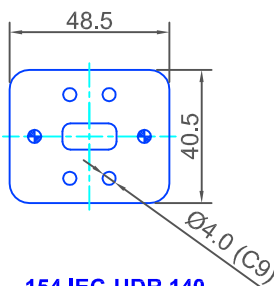

154 IEC-UDR 140

**WG18  
WR62  
R140**