

AMERICAN FLANGES

22A
CHOKE + SEALING GROOVE

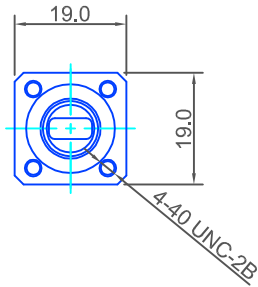

UG-600A/U
MIL-F-3922/59-005

22B
COVER / PLAIN

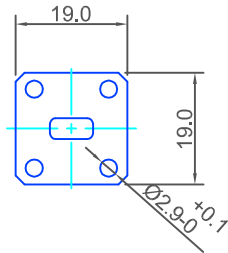

UG-599 /U
(MIL-F-3922/54-003)

22Y
SEALING GROOVE

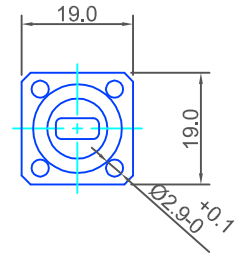

UG-599 /U *Modified*
MIL-F-3922/54-003 *Modified*

EUROPEAN FLANGES

22G
CHOKE + SEALING GROOVE

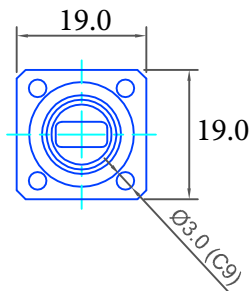

154 IEC-CBR 320

22K
SEALING GROOVE

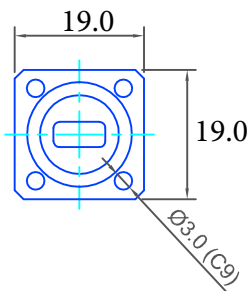

154 IEC-PBR 320

22M
COVER / PLAIN

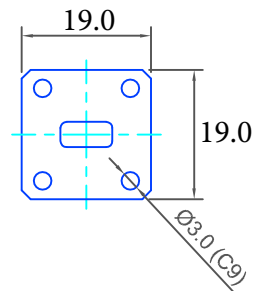

154 IEC-UBR 320