

Rigid Rectangular Waveguide - Physical Dimensions

DESIGNATION

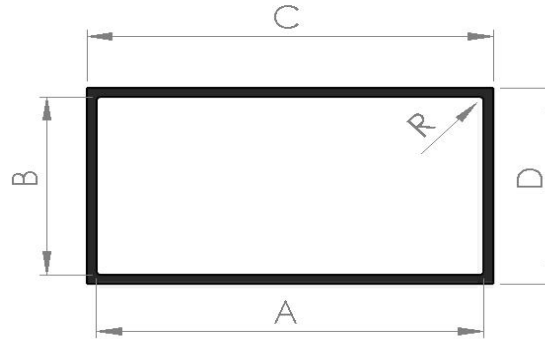

WG	WR	R	A (mm)	B (mm)	Tolerance (± mm)	C (mm)	D (mm)	Tolerance (± mm)	Nominal Wall Thickness	R Max (mm)
10	284	32	72.136	34.036	0.152	76.200	38.100	0.152	2.032	1.194
11A	229	40	58.166	29.083	0.152	61.417	32.334	0.152	1.626	0.787
12	187	48	47.549	22.149	0.127	50.800	25.400	0.127	1.626	0.787
13	159	58	40.386	20.193	0.127	43.637	23.444	0.127	1.626	0.787
14	137	70	34.849	15.799	0.102	38.100	19.050	0.102	1.626	0.787
15	112	84	28.499	12.624	0.102	31.750	15.875	0.102	1.626	0.787
16	90	100	22.860	10.160	0.102	25.400	12.700	0.102	1.270	0.787
17	75	120	19.050	9.525	0.076	21.590	12.065	0.076	1.270	0.787
18	62	140	15.799	7.899	0.064	17.831	9.931	0.064	1.016	0.406
19	51	180	12.954	6.477	0.064	14.986	8.509	0.064	1.016	0.406
20	42	220	10.668	4.318	0.051	12.700	6.350	0.051	1.016	0.406
21	34	260	8.636	4.318	0.051	10.668	6.350	0.051	1.016	0.406
22	28	320	7.112	3.556	0.038	9.144	5.588	0.038	1.016	0.203
23	22	400	5.690	2.845	0.025	7.722	4.877	0.025	1.016	0.178